

Mounting Instruction for Auxiliary Contact

(Cat.No. 1100 – SA211)

For Installing Auxiliary Contact

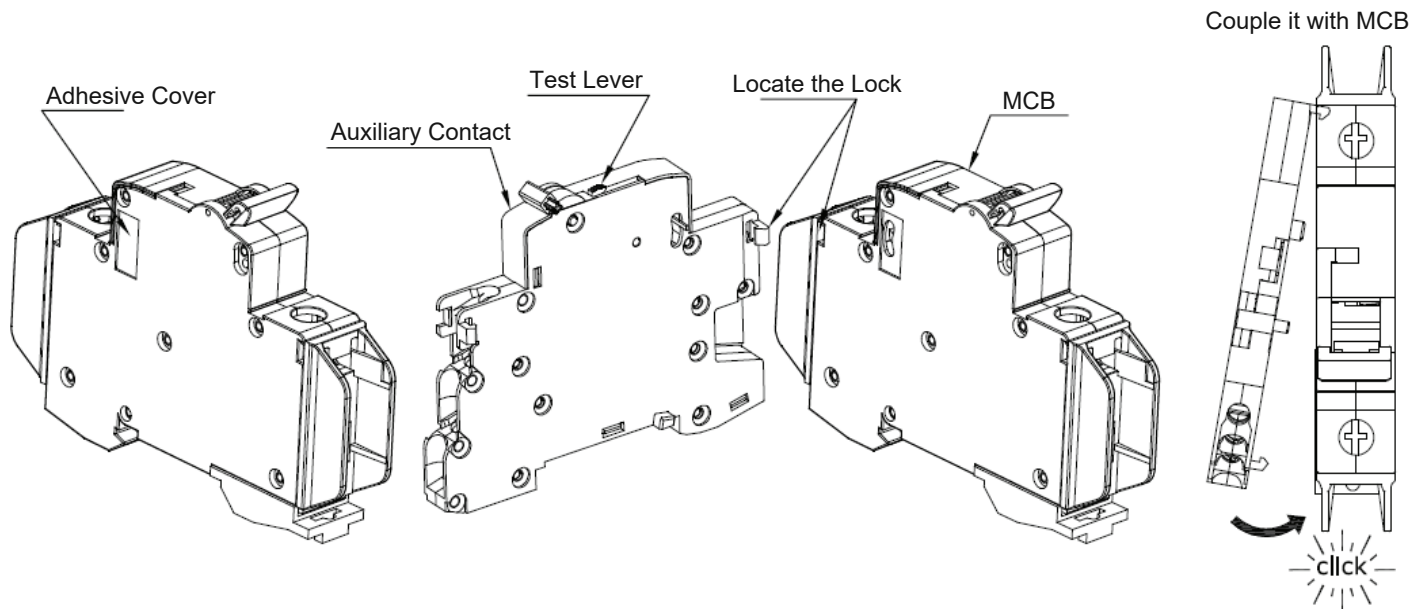

- STEP 1 – Remove adhesive cover from left side of the MCB.
STEP 2 – Locate the snap while also ensuring both the MCB and Auxiliary are in the “OFF” position.
STEP 3 – Lock the Auxiliary contact to left side of the MCB firmly.
STEP 4 – The Test lever allows testing of NO / NC contact switching without turning the circuit breaker ON.
Simply slide the Test lever in upward direction and contacts will change their state.

For Uninstalling Auxiliary Contact

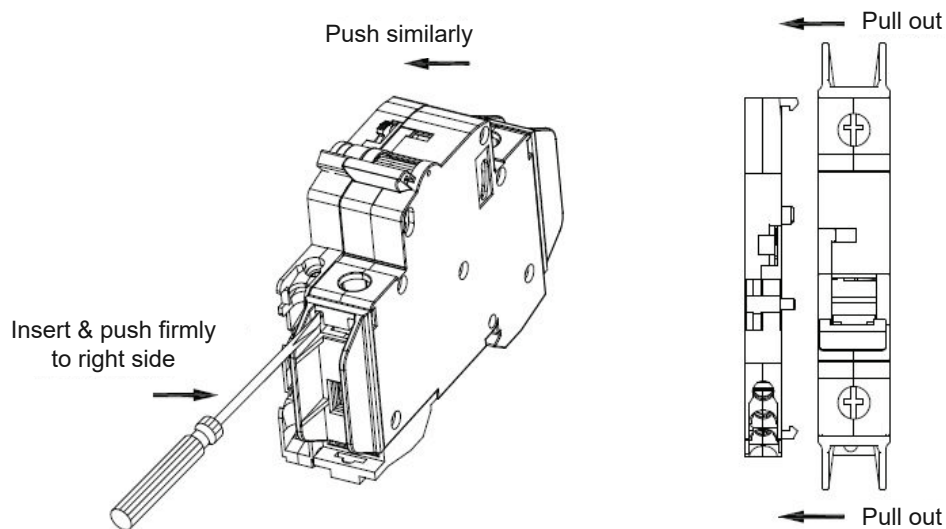

- STEP 1 – Insert the screw driver in the location as shown in the fig.
STEP 2 – Push the screw driver to the right so that Auxiliary contact detaches from MCB.
STEP 3 – Similarly do the same procedure to the opposite side.
STEP 4 – Gently pull out the Auxiliary contact from the MCB.