

PANEL MOUNT DISCONNECTS

MOUNTING INFORMATION

HANDLE HOLE PATTERN:

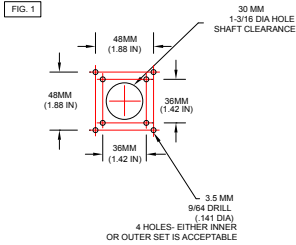

HANDLE POSITION:

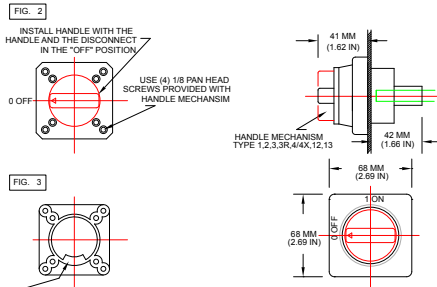

25-63 AMP DISCONNECT SWITCH DIMENSIONS:

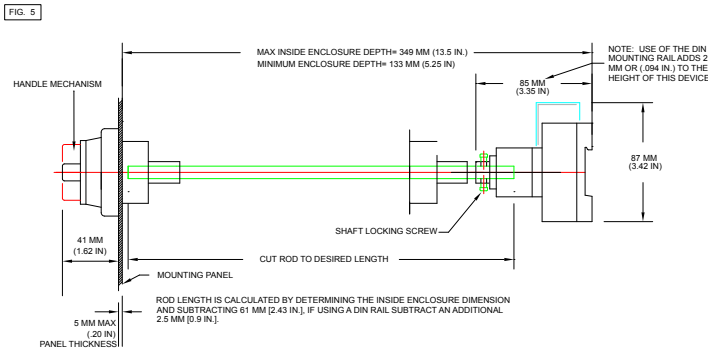

SWITCH HOLE PATTERN:

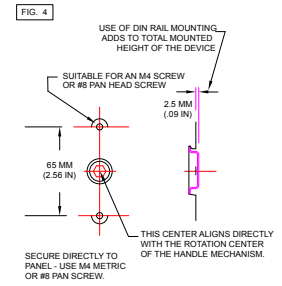

80-100 AMP DISCONNECT SWITCH DIMENSIONS:

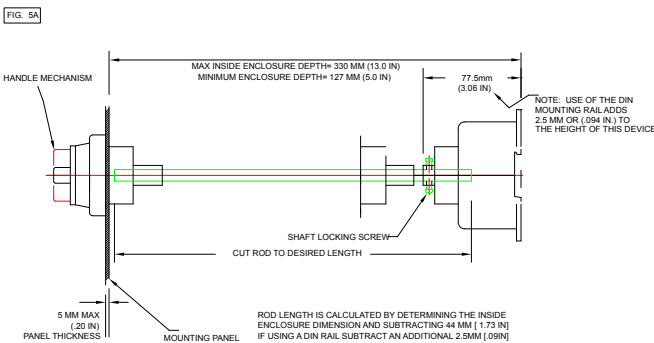

SWITCH HOLE PATTERN:

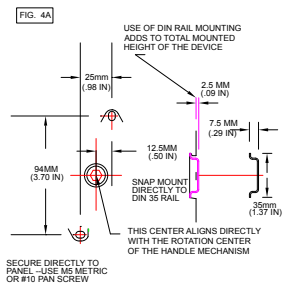

MOUNTING INSTRUCTIONS - PANEL DISCONNECT

1. Prepare the Enclosure Door/Cover with the correct mounting hole pattern as shown in Fig. 1. Only 4 mounting holes are required, use either the inner (36 mm) or outer (46 mm) set of holes.
2. The correct mounting hole pattern is a function of the switch rating that you are mounting, refer to either Fig. 4 or Fig 4A. The center of the panel mounting hole pattern is labeled, this must align with the center of the cover holes whenever the door is fully closed. Note: The center of rotation for the Handle Mechanism is on the same axis of rotation as the Disconnection Switch.
3. Based on the inside enclosure dimensions, cut the operating shaft to the correct length. Careful: Refer to Fig. 5 or 5A as the rod length varies with switch rating. If a DIN rail is used in mounting the Disconnect Switch, the rod length is reduced by an additional 2.5 mm [0.10 in.].
4. Insert the operating shaft into the hex shaped hole in the black plastic shaft adapter. This is the part that is molded with a square top and two "butterfly" shaped wings extending from either side of the part. Tighten the locking screw to secure the adapter to the operating shaft.
5. Secure the Handle Mechanism to the enclosure door using the four screws provided. Make Sure that:
 - > The arrow indicator on the handle is turned CCW as far as it will go, and that the arrow indicator points left as in Fig. 2.
 - > The thin flat seal is placed between the Handle Mechanism and the enclosure door with the flat surface of the seal resting against the door surface.
 - > Make certain that the rear door Bracket is positioned as shown in Fig. 3 -- with the interlocking flange "top" or "bottom".
 - > Recommended torque for the four mounting screws is 10 lb*in. [1.13 Nm].
6. With the Disconnect Switch mechanism rotated CCW to the "OFF" position, insert the operating shaft into the hex shaped hole in the Disconnect Switch and tighten the two locking screws. Make sure that the operating shaft is positioned in such a way that the adapter has the "wings" extending left and right, in alignment with the "OFF" position.
7. Snap on the Front Cover to complete the assembly. The "OFF" indication should be to the left as shown in Fig. 2.
8. Once installed, the enclosure door will open only if the Disconnect Switch and the Handle Mechanism are in the "OFF" position.

DOOR MOUNT DISCONNECTS

MOUNTING INFORMATION

HANDLE HOLE PATTERN:

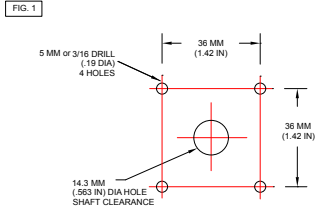

HANDLE AND BASE POSITION:

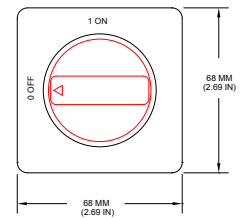
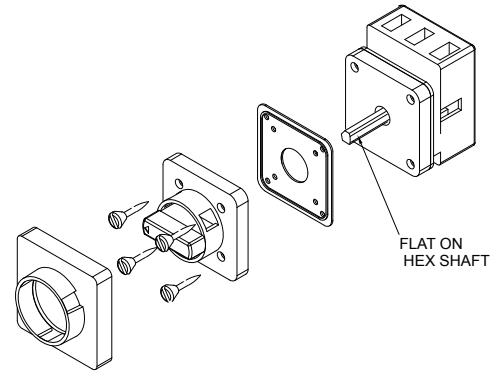
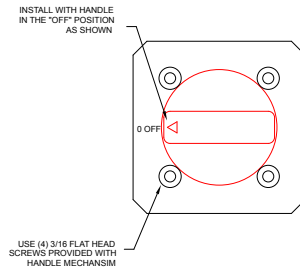
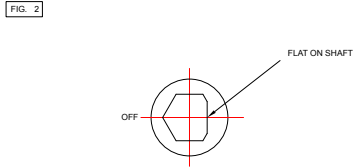

TYPE 1,2,3,3R,4/4X,12,13

SWITCH DIMENSIONS:

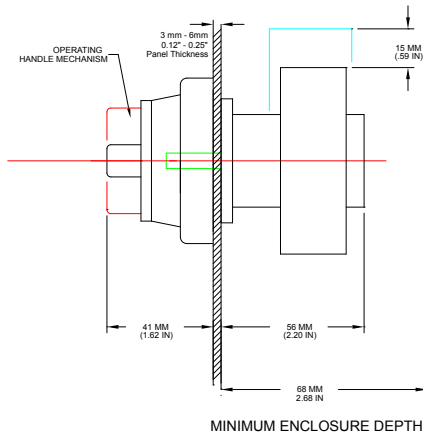

REAR VIEW:

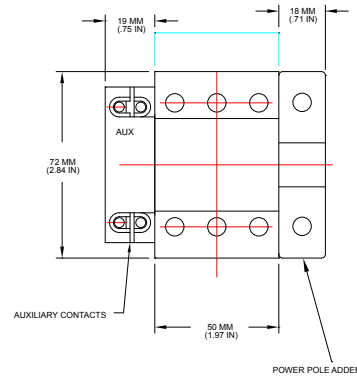

PANEL FACE VIEW:

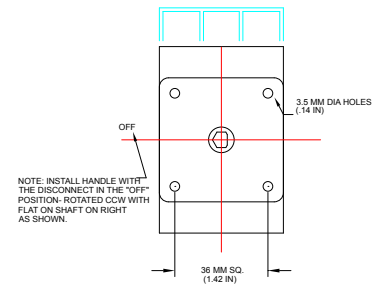

MOUNTING INSTRUCTIONS - Door Mount Disconnects:

1. Prepare the panel/door with the correct mounting hole pattern as shown in Fig. 1.
2. With the disconnect switch set in the "OFF" position (shaft rotated CCW in full against stop), align the disconnect switch on the inside of the panel door and align the four mounting holes in the switch face with the holes in the door. The "OFF" indicator on the switch should be located as shown in Fig. 2.
3. With the Handle Mechanism rotated to the "OFF" position (Fig. 2), align the mounting base with the four holes from the front of the panel door. Make sure that the thin flat seal is placed between the base and the door with the flat surface of the seal resting against the surface of the door.
4. With the Arrow on the handle mechanism pointing left in relation to the base, align the mounting base so that the din rail clip (yellow clip on the bottom of the mounting base) faces the opposite direction of the arrow of the handle mechanism. The mounting base should be flush against the panel.
5. Insert and drive the four mounting screws provided to secure the Handle Mechanism to the switch assembly. [Note- the maximum recommended torque for the four mounting screws is 10 lb*in. [1.13 Nm]].
6. Snap on the Front Cover to complete the assembly. The "OFF" indication should be to the left as shown in Fig. 2.

⚠ WARNING

- * Disconnect Power before proceeding with any work on this equipment.
- * Installation and maintenance by technical personnel only.
- * Installation of c3controls product must be in accordance with the NEC (U.S. National Electrical Code) regulations or local codes/standards per your application. Any violation of these safety requirements could result in a personal injury and/or result in damage to the equipment.

⚠ AVERTISSEMENT

- * Débranchez le Pouvoir (la Puissance) avant la suite de n'importe quel travail sur cet équipement.
- * Installation et maintien par personnel technique seulement.
- * L'installation de produit c3controls doit être conformément au NEC (le Code Électrique national américain) des règlements ou des codes/normes locaux par votre demande. N'importe quelle violation de ces exigences de sécurité pourrait aboutir à une blessure personnelle et/ou aboutir aux dégâts à l'équipement.