

CODE : 41312

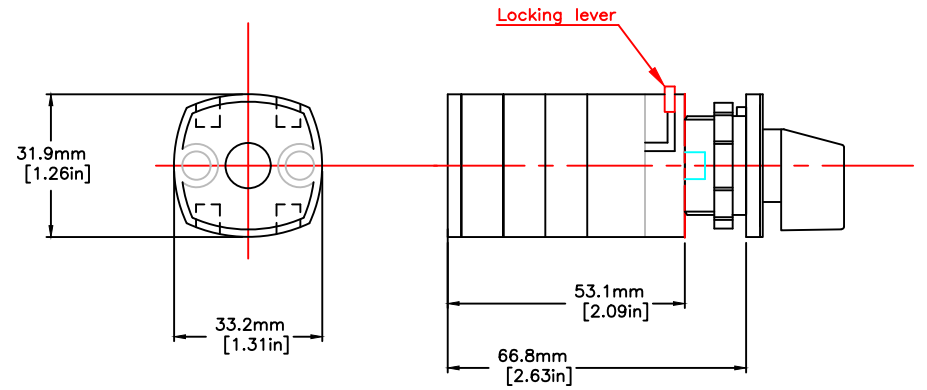

CODE : 41313

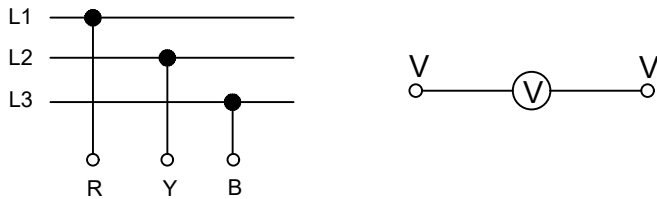
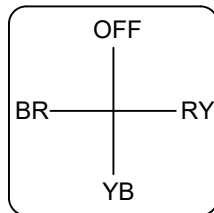
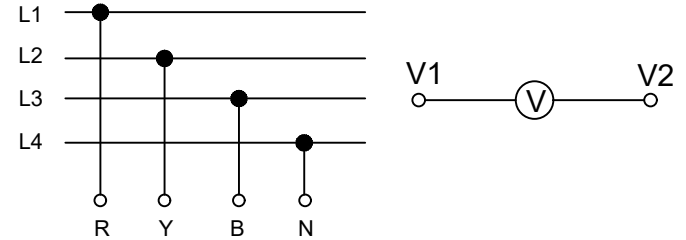

Z9312

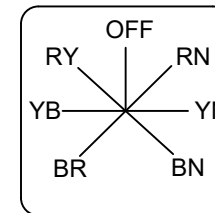

Z4313

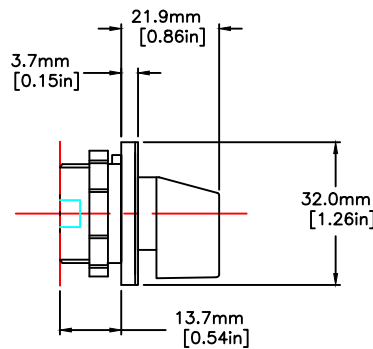
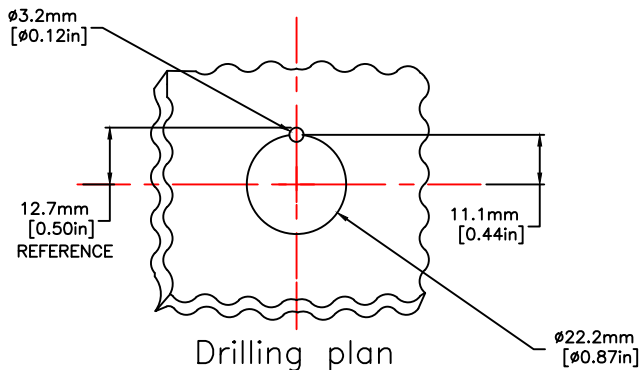

**S22 HANDLE SHOWN
ALSO SPECIFY N22 & L22**

10A

60C10040

TOLERANCE

.XX +/- 0.02
.XXX +/- 0.005
.XXXX +/- 0.001
ANGLES +/- 0.5 DEG

UNLESS OTHERWISE SPECIFIED:

This drawing is the property of c3controls. The drawing may not be copied, used or disclosed, for any purpose except as authorized in writing by c3controls.



P.O. BOX 496 BEAVER, PA 15009 www.c3controls.com

Description: **VOLTMETER SWITCH**
With OFF Position
SERIES 41312 & 41313
10A -----Product OUTLINES

Drawn By: RJJ Drawing Number: 60C10040
Date: 11-13-06 Scale: 1:1