

3/16"
1/4"

2
1

* REMOVE ONE ADDITIONAL GASKET WHEN USING A LEGEND PLATE

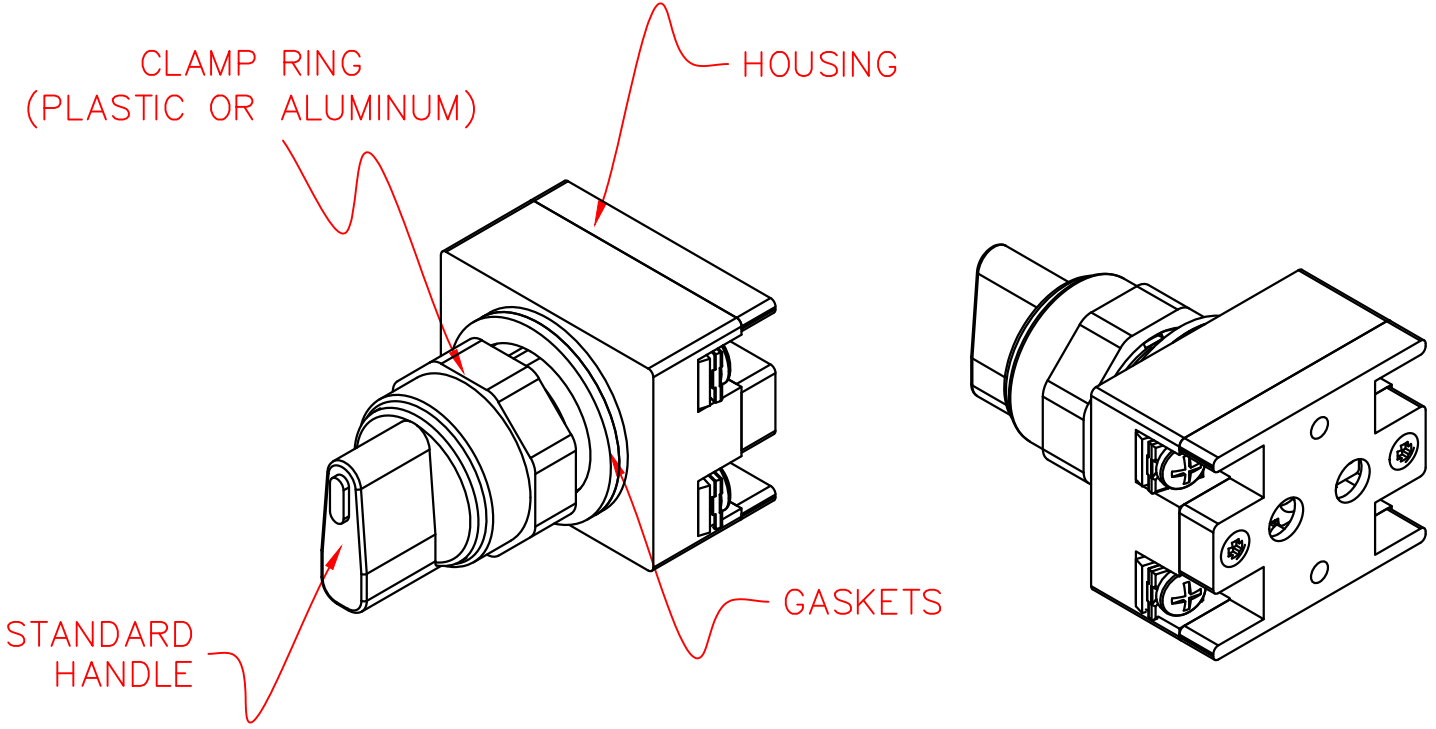
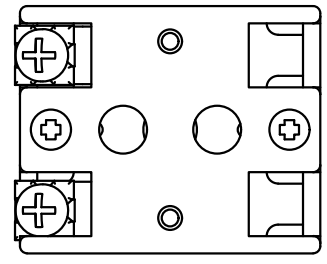
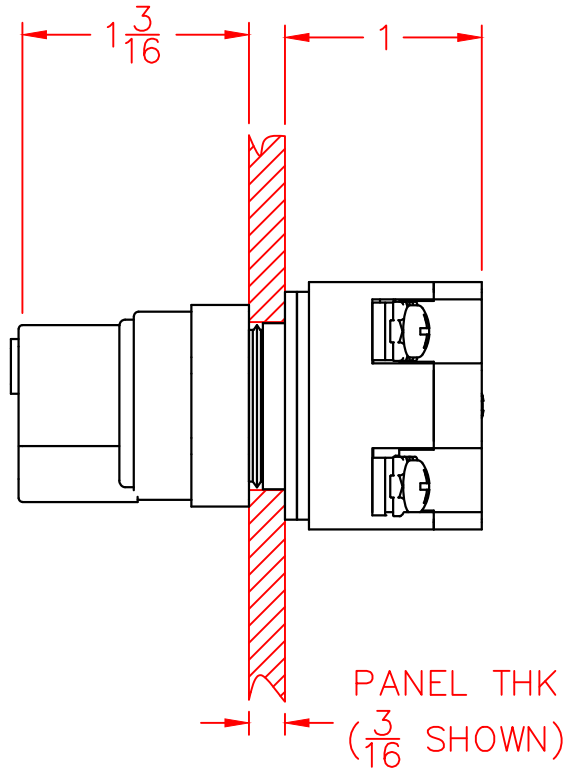
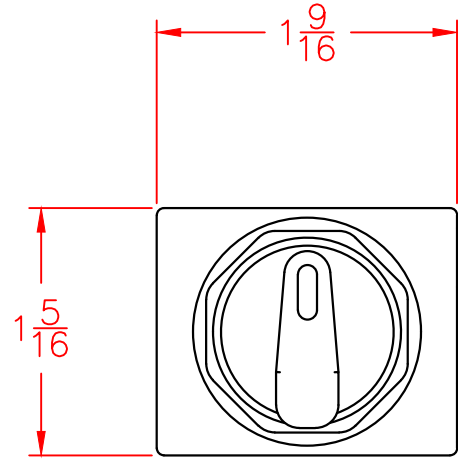

NOTES:

- 1) MOUNTING HOLE IN PANEL - $\phi 7/8$ (22MM)
- 2) CHOICE OF ALUMINUM OR PLASTIC CLAMP RING (NEMA 4 OR NEMA 4X). CLAMP RINGS FIT CONTROL CONCEPTS 22MM PRODUCT LINE
- 3) MOUNTING HOLE SPACING (FOR STANDARD LEGEND PLATES) - HORIZONTAL & VERTICAL DISTANCE - 1.750 CENTER TO CENTER

XXX	XXXXXXXXXX	XXXX	XXX	22MM PRODUCT LINE 3 POSITION SELECTOR SWITCH OPERATOR W/HANDLE MECH DATA SHEET	
XXX	XXXXXXXXXX	XXXX	XXX		
XXX	XXXXXXXXXX	XXXX	XXX		
XXX	XXXXXXXXXX	XXXX	XXX		
XXX	XXXXXXXXXX	XXXX	XXX		
XXX	XXXXXXXXXX	XXXX	XXX		
REV	DESCRIPTION	DATE	BY	DRAWN BY: RCG	DATE: 08-17-01