

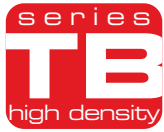

HIGH DENSITY SHORTING **TERMINAL BLOCKS**



SERIES TB PRODUCT PROFILE

c3controls' new **High Density Shorting Terminal Blocks** are a valuable addition to our widely recognized High Density Terminal Blocks (HDTB) line, now available in 2, 4, and 6 pole variants. Building on the advanced features of our HDTB, these CT Shorting Blocks simplify connections for systems in applications such as current transformers, switchgear, and tap points.

DELIVERING SUPERIOR PRODUCT QUALITY AND MANUFACTURING EXCELLENCE

✓ Proven	Our high density shorting terminal blocks meet UL and CSA standards, and are RoHS compliant. 
✓ Range of Operation	Shorting block offers flexible options from 2, 4 and 6 pole in a single molded housing rated for 600V AC, 30A (unprepared wire) and 60A (prepared wire).
✓ Multiple Wire Size	Accommodates #18 to #10 AWG (unprepared) and #18 to #6 AWG (prepared) — up to two (2) ring lugs.
✓ Convenient	c3controls high density shorting terminal blocks are directly interchangeable with GE EB27B06S terminal blocks.
✓ Wiring Made Easy	Wiring to the shorting block is made easy by unobstructed access to terminals and with screws in the fully backed-out position.
✓ Heavy-Duty Construction	We mold our terminal block housings from unbreakable thermoplastic and we use quality zinc plated brass and electrolytic copper for our metal parts for excellent conductivity and to minimize corrosion.
✓ Added Safety	Integrated IP20 guards prevent accidental contact.
✓ Time Savings	Individual blocks can be quickly and easily added or removed without disturbing adjacent blocks. Only a screwdriver is required for removal.
✓ Limited Lifetime Warranty*	Every product is backed by our limited lifetime warranty—unmatched in the industry—bringing you quality components that perform in the most demanding applications.
✓ Guaranteed Same-Day Shipping*	Product availability reduces inventory, and improves cash-flow—saving you money. With c3controls any order for standard catalog items received by 6:00pm ET is guaranteed to ship same-day.
✓ Advantage Pricing	Our approach to product development, manufacturing, and focus on servicing the OEM and Electrical Equipment Builder reduces cost. The result—the best value in the industry.

*See c3controls Terms & Conditions



UNIQUE FEATURES

1. Out of the box and ready to install! Screws come in the backed out position with convenient spring-return open terminals for easy wiring.
2. Available in 2, 4 and 6 pole configurations to choose the one that best suits your application needs.
3. Brass shorting strip to easily short terminals. Terminals can be shorted as per customer requirement.
4. Shorting block versions available with Thumb screws or Phillips screws with transparent cover.
5. Factory supplied Transparent cover along with Phillips version of high-density shorting terminal block provides additional safety and protection.
6. Large marking strip available that can be hand marked or custom printed.
7. Space provided to keep shorting terminal screws when not in use.
8. Integrated 35mm DIN Rail snap and panel mounting geometry.

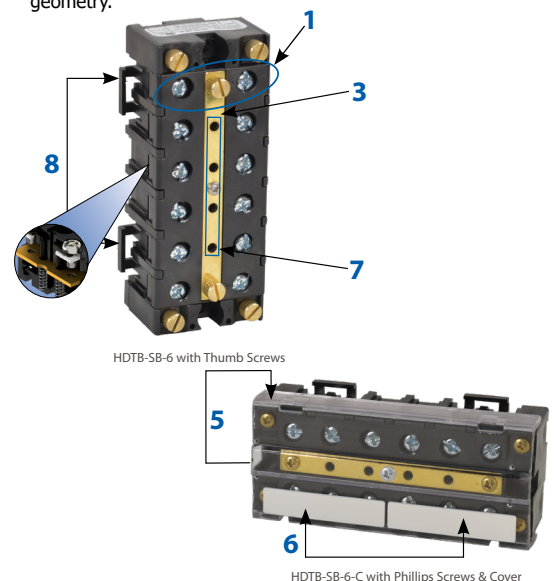

c3controls

Copyright © 2025 c3controls. All Rights Reserved.

724.775.7926 | c3controls.com

REVISION 01.2025



HIGH DENSITY SHORTING **TERMINAL BLOCKS**

SPECIFICATIONS

High Density Shorting Terminal Blocks				
		HDTB-SB-2 & HDTB-SB-2-C	HDTB-SB-4 & HDTB-SB-4-C	HDTB-SB-6 & HDTB-SB-6-C
	UNITS			
ELECTRICAL				
Voltage Rating	V		600	
Maximum Current Rating				
Unprepared Wire	A		30	
Prepared Wire	A		60	
MECHANICAL				
		UL and CSA Applications		
Conductor Material			Cu	
Conductor Range [Unprepared]	AWG		#18 to #10	
Conductor Range [Prepared]	AWG		#18 to #6	
Ring Terminal Compatibility	AWG		#18 to #6	
Maximum Terminal Tightening Torque	lb-in. / Nm		23 / 2.6	
ENVIRONMENTAL				
		UL and CSA Applications		
Operating Temperature	°C/°F		-20 to +106 / -4 to +176	
ROHS COMPLIANCE For RoHS compliance documentation by product, refer to c3controls.com.				

For complete ratings, detailed specifications, or to download product certifications visit c3controls.com.

DIMENSIONS

HDTB-SB-2/4/6

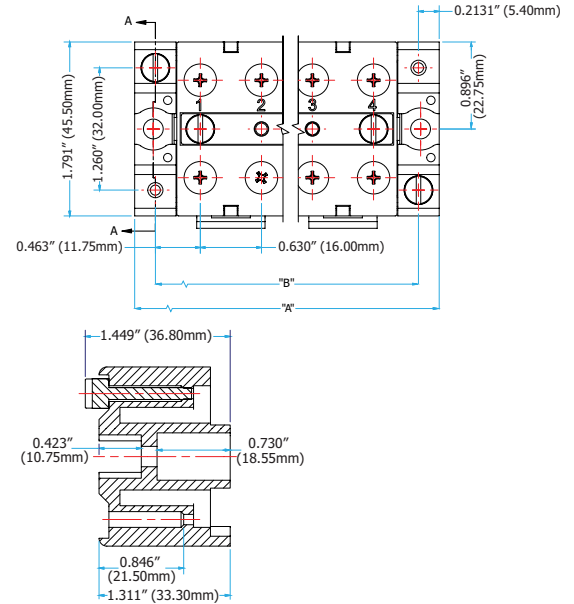

HDTB SIZES			
CATALOG #	# OF POLES	A	B
HDTB-SB-2	2	1.98" (50.30mm)	1.56" (39.50mm)
HDTB-SB-4	4	3.24" (82.30mm)	2.81" (71.50mm)
HDTB-SB-6	6	4.50" (114.30mm)	4.07" (103.50mm)

HDTB-SB-2/4/6-C

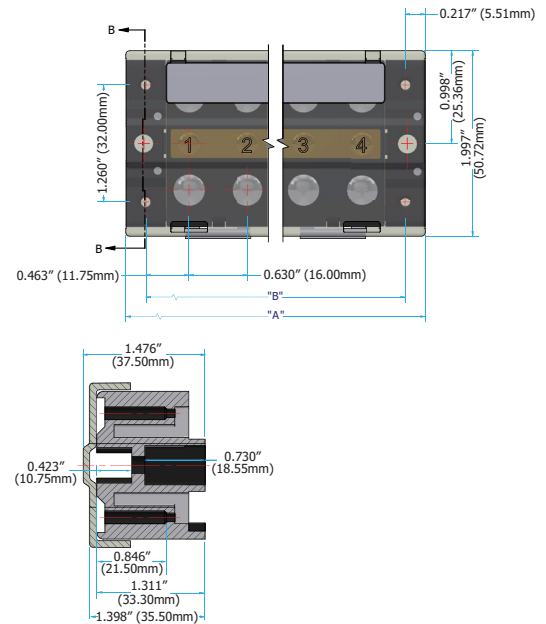

HDTB SIZES			
CATALOG #	# OF POLES	A	B
HDTB-SB-2-C	2	1.99" (50.52mm)	1.56" (39.50mm)
HDTB-SB-4-C	4	3.25" (82.52mm)	2.81" (71.50mm)
HDTB-SB-6-C	6	4.51" (114.52mm)	4.07" (103.50mm)

CERTIFICATIONS

Conformity to Standards:

UL 1059
CSA C22.2 No. 65, 188
IEC 60947-1, 60947-7

Certifications:

UL File #: E145984

CE Marked (per EU Low Voltage Directive 2006/95/EC and RoHS Directive 2011/65/EU)



c3controls

Copyright © 2025 c3controls. All Rights Reserved.

724.775.7926 | c3controls.com

REVISION 01.2025