

Mounting Instruction for Auxiliary Contact

(Cat.No. 1100 – SA211)

series
1100

For Installing Auxiliary Contact

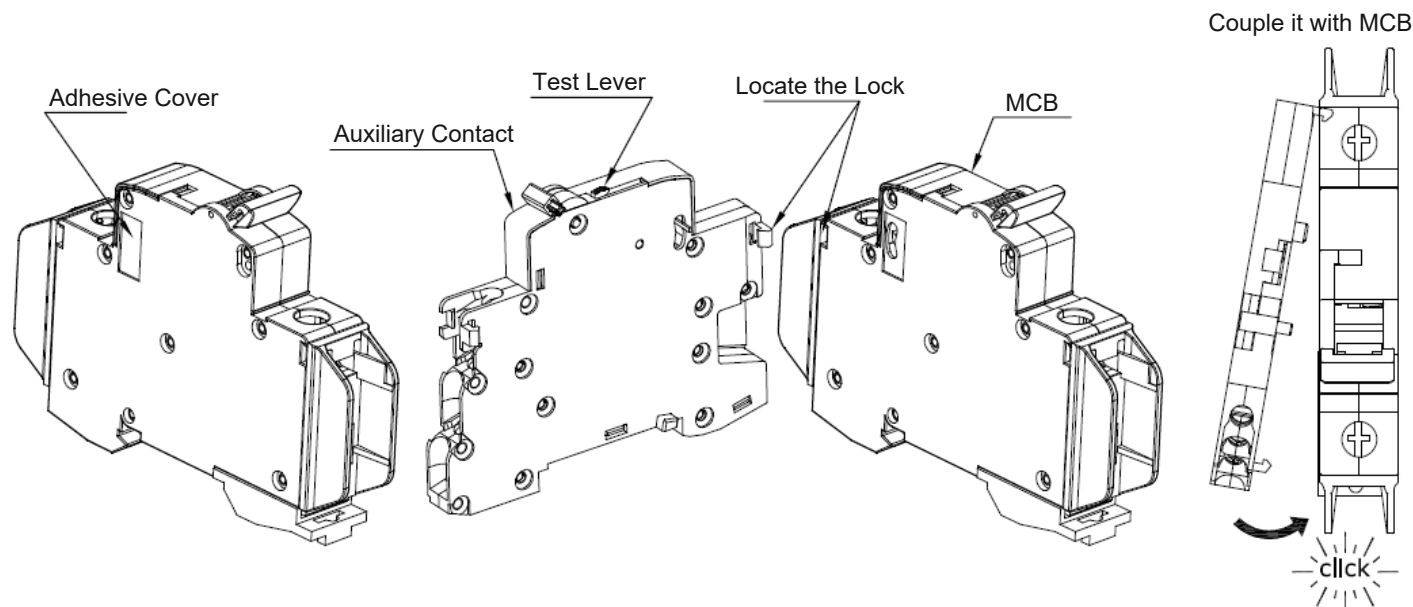

STEP 1 – Remove adhesive cover from left side of the MCB.

STEP 2 – Locate the snap while also ensuring both the MCB and Auxiliary are in the “OFF” position.

STEP 3 – Lock the Auxiliary contact to left side of the MCB firmly.

STEP 4 – The Test lever allows testing of NO / NC contact switching without turning the circuit breaker ON.

Simply slide the Test lever in upward direction and contacts will change their state.

For Uninstalling Auxiliary Contact

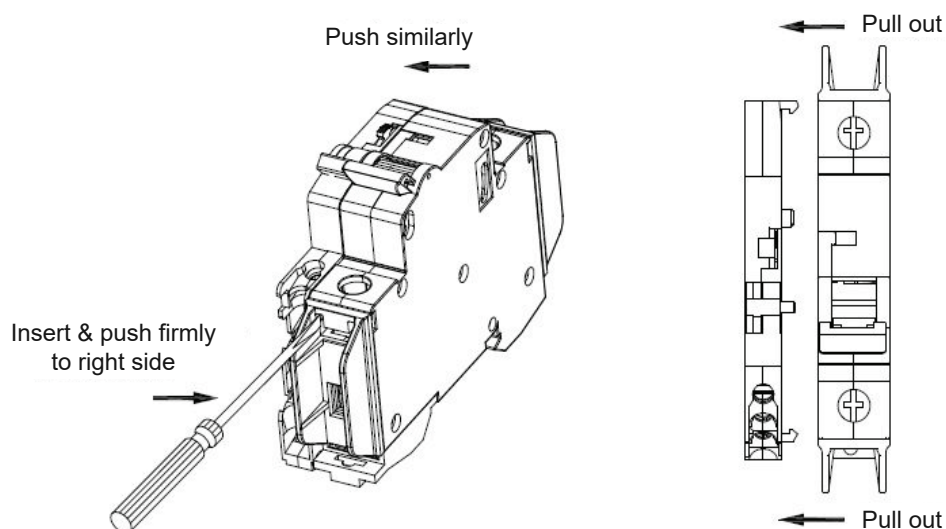

STEP 1 – Insert the screw driver in the location as shown in the fig.

STEP 2 – Push the screw driver to the right so that Auxiliary contact detaches from MCB.

STEP 3 – Similarly do the same procedure to the opposite side.

STEP 4 – Gently pull out the Auxiliary contact from the MCB.