

Mounting Instruction for Alarm Contact

(Cat.No. 1100 – STA211)

For Installing Alarm Contact

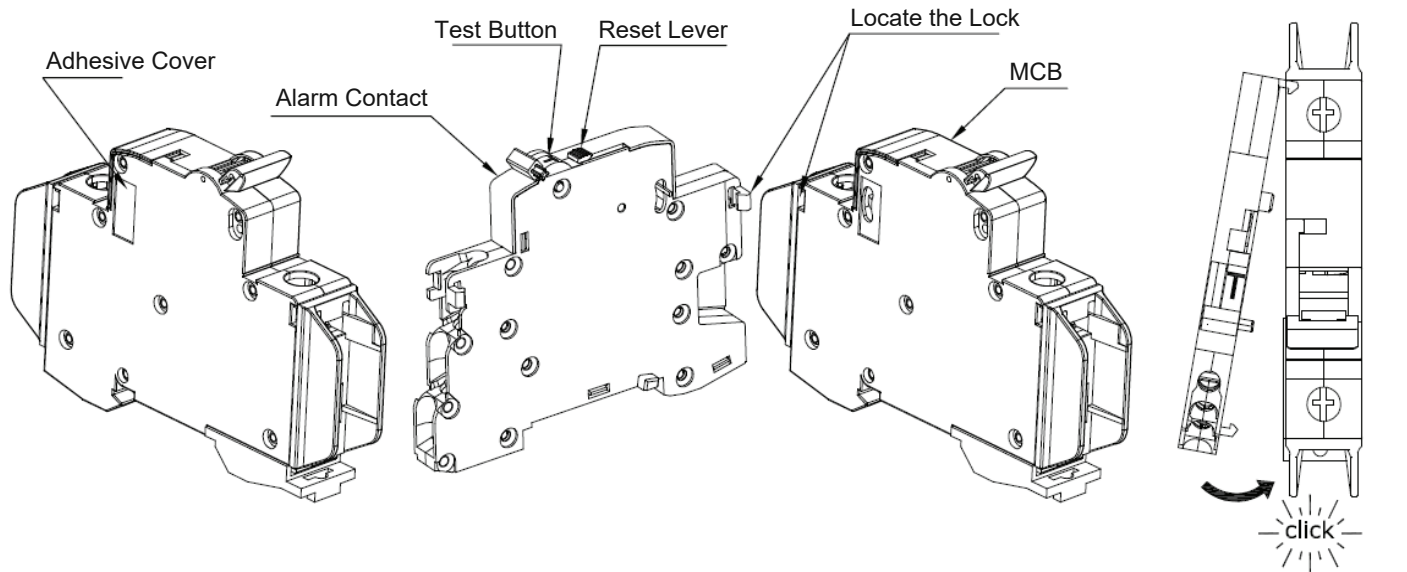

- STEP 1 – Remove adhesive cover from left side of the MCB.
STEP 2 – Locate the snap while also ensuring both the MCB and Auxiliary are in the “OFF” position.
STEP 3 – Lock the Alarm contact to left side of the MCB firmly.
STEP 4 – Test button is used to verify NO/NC contact operation without turning circuit breaker ON.
Simply, press the Test button and that will trip the Reset lever and switch the contact state.
STEP 5 – To reset Alarm contact after Circuit Breaker is tripped, move the Reset lever in upward direction before turning MCB ON.

For Uninstalling Alarm Contact

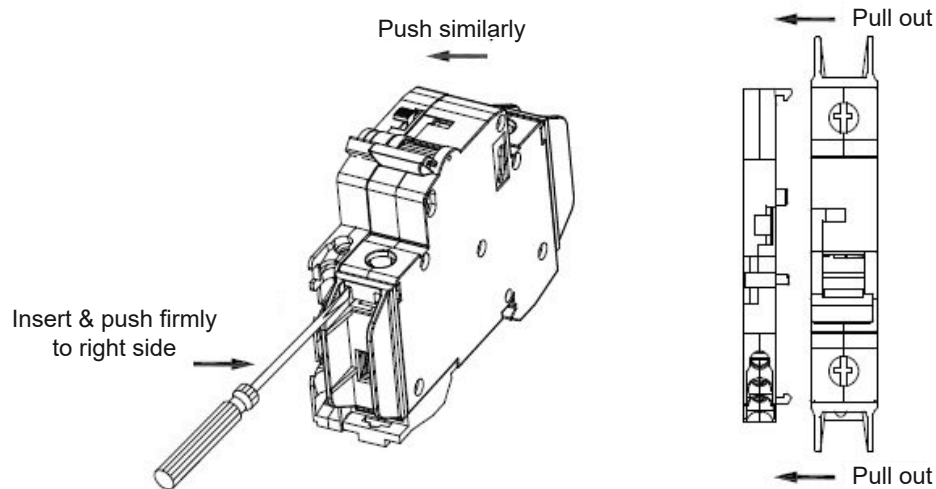

- STEP 1 – Insert the screw driver in the location as shown in the fig.
STEP 2 – Push the screw driver to the right so that Alarm contact detaches from MCB.
STEP 3 – Similarly do the same procedure to the opposite side.
STEP 4 – Gently pull out the Alarm contact from the MCB.