

ROD CUT LENGTH:
DETERMINE ENCLOSURE DEPTH AND SUBTRACT 2.75 IN [70MM]
NOTE: WITH DIN75 SUBTRACT AN ADDITIONAL .09 IN [2.5MM]

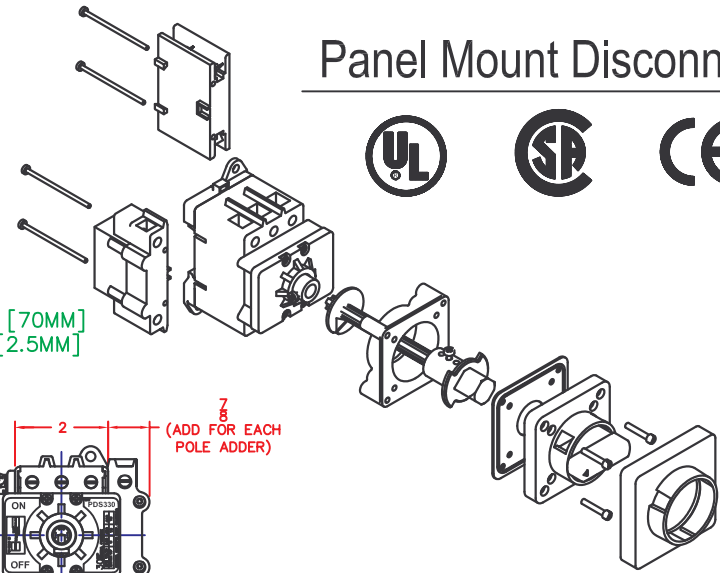

3-PHASE							
CATALOG #	GENERAL USE	120	240	480	600	TERM. TORQUE	FUSE
PDS330	600V, 30A	3hp	5hp	10hp	10hp	16-18, lb-in	35A
PDS340	600V, 40A	3hp	10hp	20hp	20hp	16-18, lb-in	60A
PDS360	600V, 60A	3hp	10hp	20hp	20hp	16-18, lb-in	70A
SINGLE-PHASE							
CATALOG #	GENERAL USE	120	240	480	600	TERM. TORQUE	FUSE
PDS330	600V, 30A	2hp	5hp	10hp	10hp	16-18, lb-in	35A
PDS340	600V, 40A	2hp	5hp	10hp	10hp	16-18, lb-in	60A
PDS360	600V, 60A	2hp	5hp	10hp	10hp	16-18, lb-in	70A

TECHNICAL SPECIFICATIONS

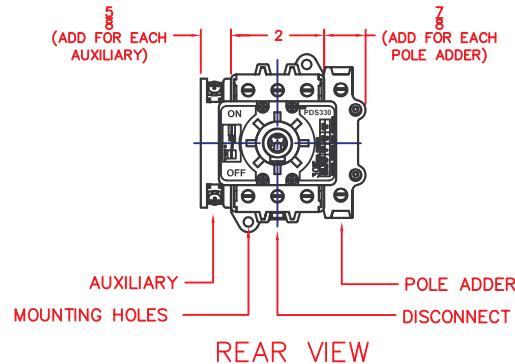
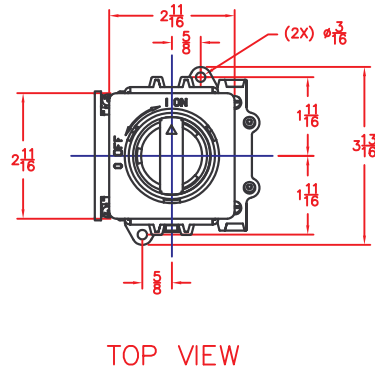
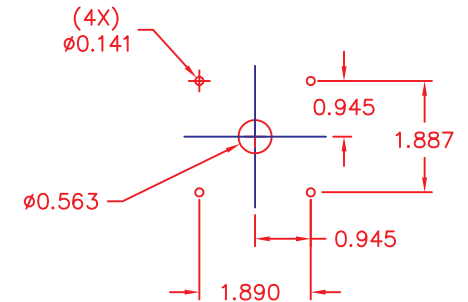

MOUNTING HOLE PATTERN FOR PANEL MOUNT DISCONNECT

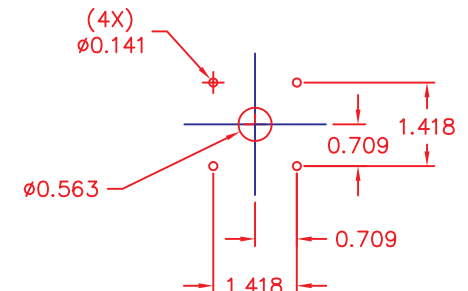

- 1) These devices are suitable for use on circuits capable of delivering not more than 10,000 rms symmetrical Amperes, 600V ac max when protected by Class J fuse.
- 2) Wire - Use copper conductors only, range 6 - 14 AWG (60°/75° C)
- 3) Handle Mechanism - Suited for use in Type 1, 2, 3, 3R, 4, 4X, 12 and 13 applications when used on a flat surface of an enclosure that is rated appropriately.