

SWITCH DEPTH= SINGLE STAGE + 11.9mm  
PER ADDITIONAL STAGE

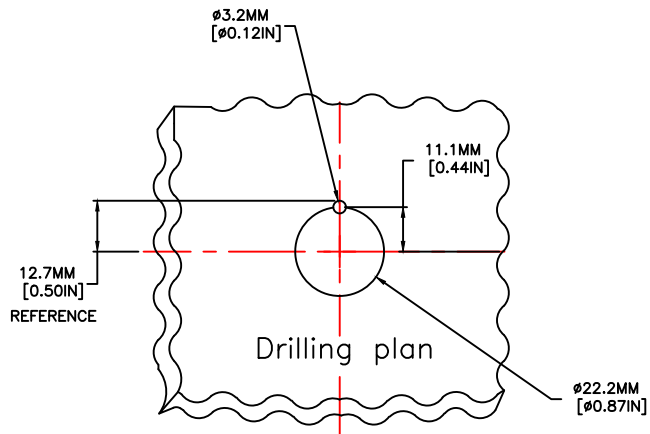

Maintained 60°

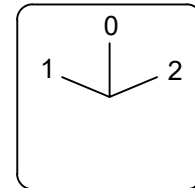

B61 & C62

1 to 6 Poles

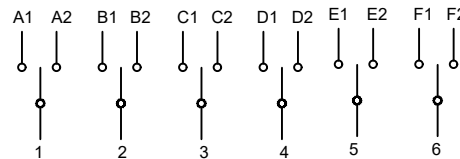

CODES: 210\*\*

16A

**60C10020**

<p>TOLERANCE:          .XX ± 0.02          .XXX ± 0.005          .XXXX ± 0.001          ANGLES ± 0.5 DEG          UNLESS OTHERWISE SPECIFIED</p>		<p><b>c3controls</b>  <small>since 1978</small></p>	
<p>P.O. BOX 496 BEAVER, PA 15009 www.c3controls.com</p>		<p>Description: "CHANGEOVER" Cam Switch          SERIES 210XX          16A          Product OUTLINES</p>	
<p>This drawing is the property of c3controls. The drawing may not be copied, used or disclosed, for any purpose except as authorized in writing by c3controls.</p>		<p>Drawn By: RJJ</p>	<p>Drawing Number: 60C10020</p>
<p>Date: 11-10-06</p>		<p>Scale: 1:1</p>	<p>60C10020</p>